

PowerMags capture the nails

Got nails? Get the HD Trimmer!

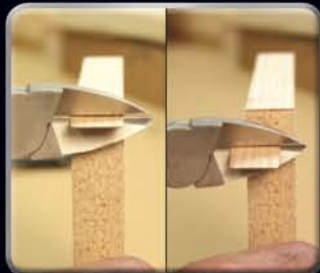

Perfect flush cut every time...

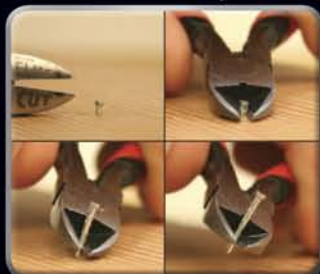

Micro but mighty

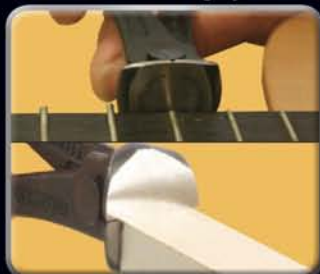

Cutting Fastedge



Cut flush with the surface...every time!



Great for laminate or wood veneer

Flush Cut Series

Heavy Duty Flush Cut Trimmers™

Let's get down and dirty! The **Heavy Duty (HD) Flush Cut Trimmers™** cut nails flush. Any questions? These things ROCK and once you use them you will leave your other cutters at home! (Not recommended for hardened screws). Comes with two high powered neodymium magnets to help catch metal debris.



Macro Flush Cut Trimmers™

The **Macro Flush Cut Trimmer™** allows you to trim edgebanding or veneer flush with the surface. These innovative new trimmers "**Stop The Struggle™**", saving you time and money. They are the first tool you will pull out of your bag every time! If, for some reason, you don't get the perfect cut the first time, these amazing trimmers allow you to make a micro cut for the perfect nip and tuck. Works great with wood and PVC edgebanding with standard thicknesses of .018" - .025". (Not recommended for 3mm edgebanding, nails or screws).

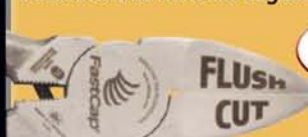

Comes with a Sumo Strap Holster!



Micro Flush Cut Trimmers™

The **Micro Flush Cut Trimmers™** flush cutting surface is slightly rounded, allowing you to get extra close in tighter areas. This design allows you to get into tight spots when removing brad nails or small slivers. Gently pull the nail out by rolling the **Micro Flush Cut Trimmers™** without marring or denting the wood. Also works great for electrical wiring, trimming plastic parts, fishing lines, etc. (OK to pull nails, not recommended for cutting nails).



End Nippers™

Back in 1978, in my guitar building days at Taylor Guitars, Bob Taylor taught me the cool trick of grinding a conventional pair of end nippers smooth so they could cut fret wire flush. Forget the grinding, we did it for you. The **End Nippers™** can be used for cutting fret wires, up to 3mm edgebanding and a variety of other applications. (Not recommended for cutting nails, but great for soft metals like brass and copper).



Power Shears™

Whether you are cutting wood veneer, laminate or lace, the **Power Shears™** are the most incredible scissors you will ever use. Small and compact, yet razor sharp to cut through the toughest material like canvas and burlap, and even aluminium.



Description	Part Number	
Power Shears	POWER SHEARS	
Micro Flush Cut Trimmers	PLIERS-MICRO	
End Nip Trimmers	PLIERS-END NIP	
Macro Flush Cut Trimmers	PLIERS-FLUSH CUT	
(HD) Heavy Duty Flush Cut Trimmers	PLIERS-HEAVY DUTY	



ALWAYS WEAR EYE PROTECTION

Patent Pending