

Hinge Adjustments

CLIP Top series
107°, 120°, & Thick door hinges
(straight plate applications)

Side Adjustment

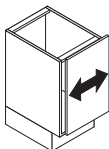

Turn front screw clockwise to increase door overlay, counter-clockwise to decrease.
Range = $\frac{5}{32}$ " (4mm)

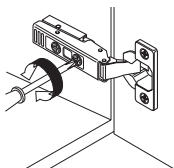

Depth Adjustment

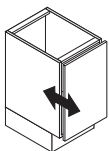

Rotate back screw to adjust door position.
Range = $\frac{3}{16}$ " (5mm)

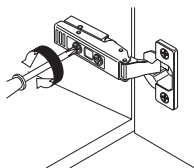

Height Adjustment

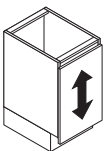

Rotate cam screw to adjust door height up or down.
Range = $\frac{5}{32}$ " (4mm)

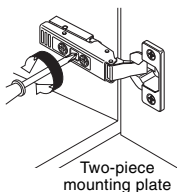

Door Removal and Installation

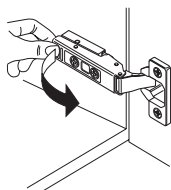

Release the lever under the hinge arm to remove.

To reinstall, place the hinge on the mounting plate and push the back with finger pressure. The "CLIP" sound confirms a secure attachment.

