

Boring Pattern

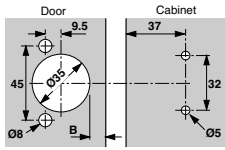

Minimum Reveal

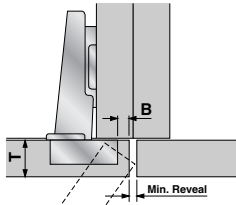

R Minimum Reveal Table

B	T	16	18	19	20	22	24
		3	0.6	1.0	1.3	1.7	2.5
4	0.6	1.0	1.3	1.6	2.4	3.7	
5	0.6	1.0	1.2	1.5	2.2	3.5	
6	0.6	1.0	1.2	1.4	2.0	3.3	

Table applies to all applications

Cross reference the door thickness (T) to the boring distance (B) on your application to find the minimum reveal

Overlay Applications

Straight Hinge

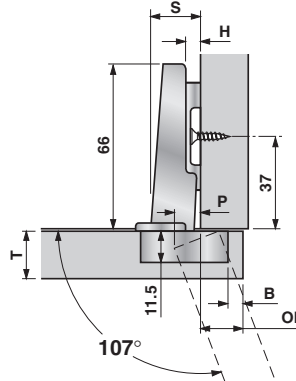

H Plate Ht.	OL Overlay Table				Interior Clearance	
	B Bore Distance				P	S
0	3	4	5	6	10	21
3	14	15	16	17	13	24
6	11	12	13	14	16	27
9	8	9	10	11	19	30

Fixed Distance (X) = 11

$$\text{Overlay (OL)} = \text{Boring Distance (B)} + \text{Fixed Distance (X)} - \text{Plate Height (H)}$$

$$\text{OL} = \text{B} + \text{X} - \text{H}$$

Swing Type Cup Mount

Self-Closing 	Screw-on 	B075T1550 Each (50) (250)	Note: the half cranked 107° and the free swing 107° straight arm hinges have been discontinued. Suggested replacements: 110° half cranked hinges, free swing 110° straight arm hinges and 86° angle restriction clips for 110° hinges Search: BLUMOTION WITHOUT BLUMOTION SELF CLOSE
	Press-in 	B075T1580 Each (50) (250)	
	INSERTA 	B075T1590B Each (50) (250)	
		Mounting plates sold separately see Related Products	BLUMOTION soft-close add-on B973A0500.01