

blum® Cabinet Door Lift Systems

AVENTOS HF Bi-Fold Lift System



AVENTOS is an exceptionally easy-opening bi-fold lift system. Even heavy doors feel weightless & can be easily opened or left at any height.

**PREMIUM
PRODUCT**

- Door width range of 15" - 72"
- Combined door height range of both doors 19" - 42"
- Quick assembly and removal
- Fast and precise adjustment
- Integrated tension adjustment for door weight
- Extremely durable
- Works with face frame and frameless cabinets
- Lift mechanisms come with 120° hinges



Inside cabinet view of lift mechanism.

Accessories



Restricts opening angle of top hinges to 104°. Use when crown molding or low clearance is an issue.

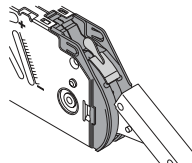
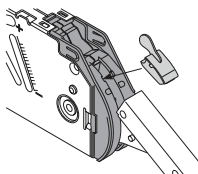

Use to pre-bore for lift mechanism locating pins.

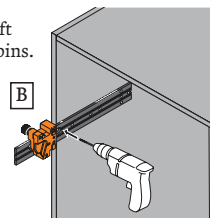

Screws included

Ordering Instructions

Lift Mechanism

Determine power factor (see below)
Order 1 set per opening.

Telescopic Arms

Determine overall cabinet height (see below)
Order 1 set per opening.

Hardware Pack

Includes 2 choices of 2 top door hinge for both ½" and 1¼" overlay, 2 bottom door hinges & arm mounting plates.
(Note: Doors over 48" wide or 26.5 lbs. require 3 hinges, find under accessories)
Order 1 pack per opening.

Power Factor Calculation

Calculate the power factor to determine the correct lift mechanism for your application.

Power Factor = Cabinet height in inches times combined door weight plus the handle.

Cabinet Height

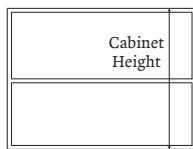

Lift Mechanisms

Dark Gray

B20F2200.N5 DGK

"Power Factor" 231-470

B20F2500.N5 DGK

"Power Factor" 471-880

B20F2800.N5 DGK

"Power Factor" 780-1440

Light Gray

B20F2200.N5 LGK

"Power Factor" 231-470

B20F2500.N5 LGK

"Power Factor" 471-880

B20F2800.N5 LGK

"Power Factor" 780-1440

White

B20F2200.N5 WHK

"Power Factor" 231-470

B20F2500.N5 WHK

"Power Factor" 471-880

B20F2800.N5 WHK

"Power Factor" 780-1440

Telescopic Arms, Nickel

B20F3200

For Cabinet Height 19" to 22"

B20F3500

For Cabinet Height 22" to 27"

B20F3800

For Cabinet Height 27" to 35"

B20F3900

For Cabinet Height 35" to 42"

Hardware Pack

B78Z550ATA6

Hardware for Narrow Aluminum

B78Z5530TA8

Hardware for Wood and Wide Aluminum Doors

Accessories (see note at left)

B032.4630

1¼" Overlay Top Door Hinge

B078Z5530T

Bottom Door Hinge

B175H6000

Bottom Door Plate

B175H3100

Inline Plate for Overlay Options

A B20F7051

104° Angle Restriction Clip

B20F7011

83° Angle Restriction Clip

B B065.1051.02

Universal Boring Template

B175H3F00

Mounting Bracket for Large Door

Overlay with 5 Piece Doors

B20F6001

Mounting Bracket for Faceframes

Call if you would like us to email you an AVENTOS electronic worksheet. The worksheet will determine for you the parts needed and the drilling specifications for your application.